

# ring

Contact Sensor  
For Ring Alarm

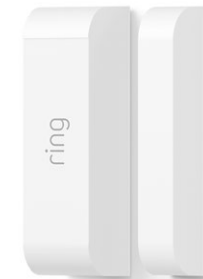

## Home security beyond the front door

Ring Video Doorbells and Cameras create a Ring of Security around your entire property.

Ring Alarm is the security system that takes your Ring of Security a step further, giving you another level of protection for your property.

Now, you can arm and disarm your system and monitor your home, all from your phone, tablet or PC.

## Contents

1. Diagram
2. In-app Setup
3. Pairing the Sensor
4. Physical Installation
5. Additional Information

# 1. Say hello to your Ring Contact Sensor.

## Diagram

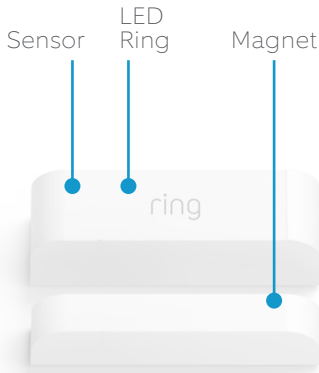

# 2. Set up your Ring Contact Sensor in the Ring app.

## Set up your Ring Contact Sensor near your Base Station

To add devices to your Ring Alarm, it must be disarmed. If your Ring Alarm is armed, please disarm it now.

In the Ring app, choose **Set Up a Device** and find Ring Contact Sensor in the **Security Devices** menu.

To complete the setup process, follow the in-app instructions.

# 3. Connect your Ring Contact Sensor to your Base Station.

When prompted, scan the QR Code or enter the PIN

The QR Code and PIN can be found on the back of your device, on the box, or on the card in this box.

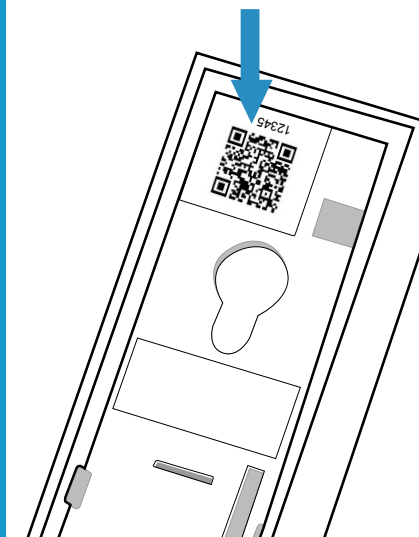

#### Pull the tab on the Contact Sensor

This connects the battery and turns on the Sensor. Your Base Station finds it automatically.

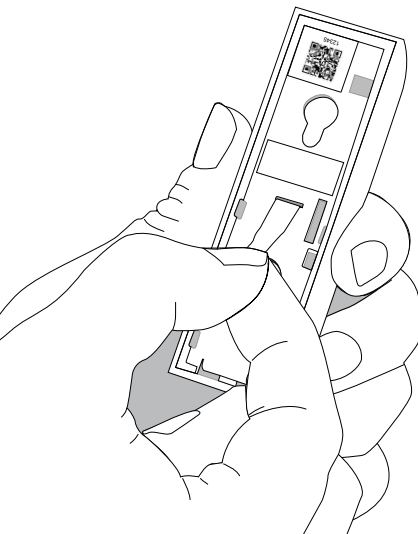

#### Track the connection progress of the Sensor

Your Sensor will try to connect to your Base Station. The Sensor's LED ring lets you track the progress.

##### LED Status Patterns:

Connected  Blue Solid (5 sec)

Door or window open  Blue Blink (1x)

Sensor tampered  Blue Blinks (3x)

#### Open and close the sensor to test it

Make sure the app shows that the sensor is open when you pull it apart.

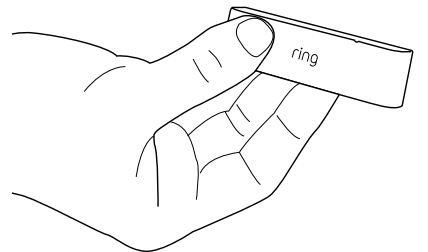
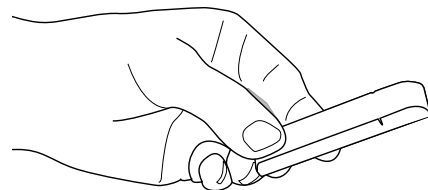

## 4. Install your Ring Contact Sensor on the wall.

#### Place your Sensor (but don't install it yet)

Hold the Sensor where you want to install it. Place it near an edge of the door or window that will move.

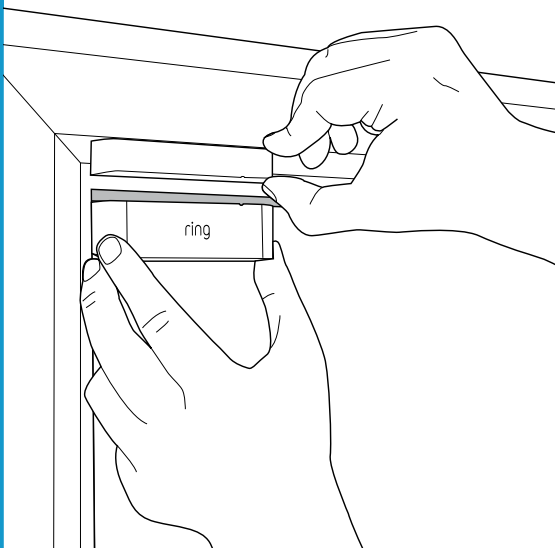

#### Align the magnet and the sensor

Place the magnet on the trim near the sensor so that the lines on the sensor and magnet are parallel. The magnet and sensor can be a maximum of 1/2" apart.

Alignment lines



#### Install your Sensor on a door or window

Use the bracket and tape or screws included in your kit.

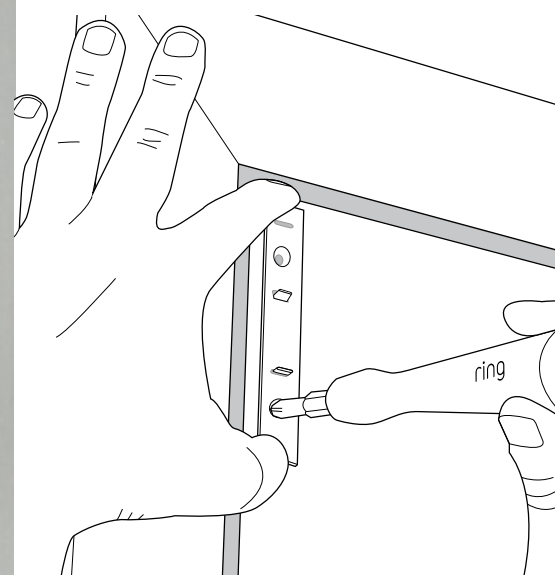

## 5. Additional information.

#### How to change the battery

Press the clip and remove the sensor cover. Replace the battery with a fresh CR123A cell.

