

About the case

The Ring Jobsite Security Case is a protective case for the Ring Alarm Pro and two Ring Power Pack backup batteries.

Ring Power Packs, and Quick Release Battery Packs may be sold separately.

On the Outside

Exterior case features include:

1. A **hardshell plastic exterior** to protect everything inside from water, dirt, debris, and possible damage.
2. An **easy carry handle** to grab and go.
3. A security padlock and key.
4. Secure latches to keep the lid closed.
5. A **power cord** used to power the internal fan and internal devices.
6. **Mounting plates designed for floor or wall mounting** (not shown).

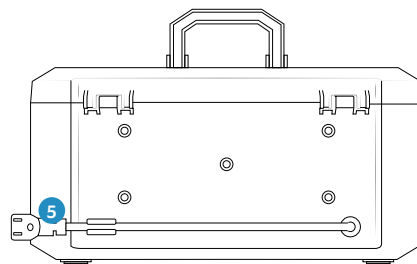
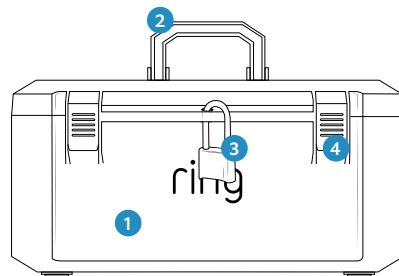

On the Inside

Inside the Ring Jobsite Security Case you'll find compartments for everything:

1. A **slot for your Alarm Pro** so it sits snugly inside.
2. **Two Ring Power Pack slots** so you can provide battery backup for your Alarm Pro.¹
3. An **outlet** for the Alarm Pro power adapter, and a **cord organizer** to keep it neat.
4. **Charging compartment** for Two Quick Release Battery Packs.²
5. Internal fan to keep air circulating to reduce the chance of overheating.

Using the fan

The fan will turn on and off automatically, and is designed to move air around the case.

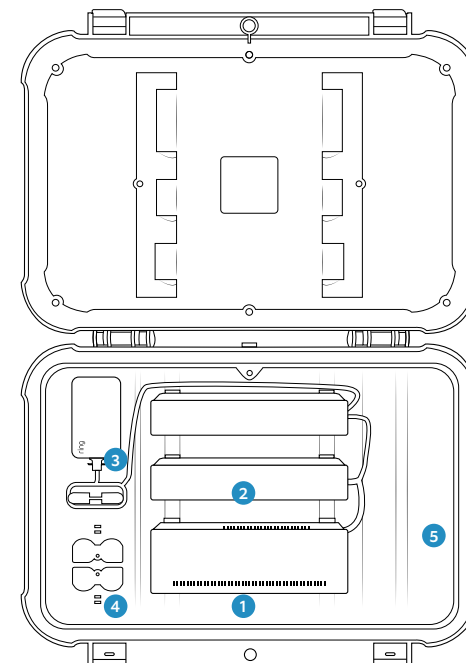

¹Ring Power Pack provides backup power to Alarm Pro during power outages.

²Ring Quick Release Battery Pack provides backup power to the internal fan inside the Jobsite Security Case during power outages.

Wall mounting instructions

1. Attach the mounting plate to the wall using the 4 screws and anchors included in Bag A.
2. Attach the two hook brackets to the back side of the case using 2 screws per bracket included in Bag B.
3. Similar to how you might mount a TV, slide the case onto the mounting plate using the hook brackets, then secure the case by inserting a screw from Bag B into the top of each hook bracket.

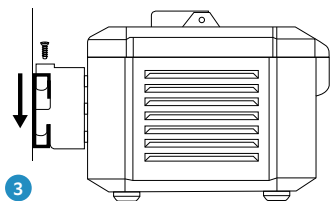
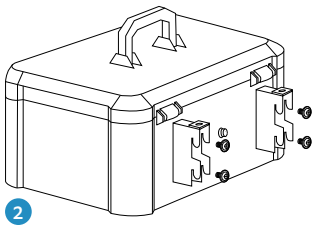
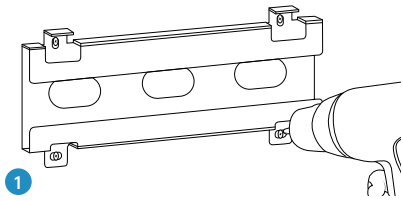

Floor mounting instructions

1. Attach the floor mounting plates to the bottom of the case using 2 screws for each plate from Bag B.
2. Secure the floor mounting plates to the floor or a beam using the included screws and anchors. Use 2 for each plate from Bag C.

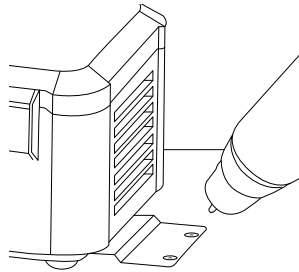
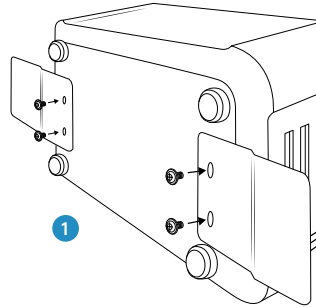

2

Setting Up Your Case

Make sure you've set up your Ring Alarm Pro in the Ring app before adding it to the case.

1. Ring Alarm Pro

- Insert your Alarm Pro correctly into the first compartment, using these steps:
- Turn the device so the top of the system is facing you and the bottom is facing the back of the case.
 - Next rotate it so the USB-C power ports are on the right side.
 - Make sure the air vents are not blocked.

2. Power Adapter

Plug the power adapter from your Ring Alarm Pro into the Alarm Pro's Power-In port.

3. Plug in the case.

Plug in the case's power cord to a GFCI outlet.

4. Ring Power Pack (up to 2, optional)

- Insert and setup your Power Packs correctly into the second and third slots, using these steps:
- Turn the device so the top of the Power Pack is facing you and the bottom is facing the back of the case.
 - Next rotate it so the USB-C power ports are on the right side.
 - Connect any Power Packs to your Ring Alarm Pro using the short, double-sided USB-C cable. Match the blue and orange connector ends to the correct Power In (orange) and Power Out (blue) ports.

5. Quick Release Battery Pack (up to 2, optional)

Insert each one into the correct slot.

A few things to note...

- We recommend installing your Ring Jobsite Security Case away from heat sources to minimize the chance of overheating.
- We suggest keeping it away from standing water for extended periods of time. Keep in a dry area whenever possible.
- Don't put the Jobsite Security Case inside another enclosure. It can interfere with fan operation and Alarm Pro's cellular and wifi signals.
- Use the included lock and brackets to secure the case as needed.
- Use this product with ground fault circuit interrupter (GFCI) outlet.

To download this manual, visit ring.com/alarm-manual
For additional help, visit ring.com/help

Ring LLC 1523 26th St. Santa Monica, CA 90404 USA

© 2021 Ring LLC or its affiliates.
Ring and all related marks are trademarks of Ring LLC or its affiliates.

xx-xxxxxx-xx