

# ring

## Spotlight Cam Hardwired Kit



Spotlight Cam for illustration purposes. Camera not included.

**ENGLISH**

## ⚠ IMPORTANT PRODUCT INFORMATION

Use **Responsibly**. Read all instructions and safety information before use.

**SAFETY INFORMATION: FAILURE TO FOLLOW THESE SAFETY INSTRUCTIONS COULD RESULT IN FIRE, ELECTRIC SHOCK, OR OTHER INJURY OR DAMAGE.**

⚠ Small parts contained in the Spotlight Cam Hardwire Kit may present a choking hazard to small children. Keep small parts away from children.

### Terms of Service and Warranty

Use of the product is subject to your registration with Ring and your agreement with the Terms of Service found at [www.ring.com/terms](http://www.ring.com/terms).

To review your warranty coverage, please refer to the enclosure inside this box or visit [www.ring.com/warranty](http://www.ring.com/warranty).

### RECYCLING YOUR DEVICE PROPERLY

In some areas, the disposal of certain electronic devices is regulated. Make sure you dispose of, or recycle, your device in accordance with your local laws and regulations. For information about recycling your device, go to [www.amazon.com/devicesupport](http://www.amazon.com/devicesupport).

## ⚠ RENSEIGNEMENTS IMPORTANTS CONCERNANT LE PRODUIT

Utiliser le produit de manière responsable. Lire toutes les instructions et les consignes de sécurité avant utilisation.

**CONSIGNES DE SÉCURITÉ : LE NON-RESPECT DES PRÉSENTES CONSIGNES DE SÉCURITÉ POURRAIT CAUSER UN INCENDIE, UNE DÉCHARGE ÉLECTRIQUE OU UNE AUTRE FORME DE BLESSURE OU DE DOMMAGE.**

⚠ Les petites pièces contenues dans le Spotlight Cam Hardwire Kit peuvent présenter un risque d'étouffement pour les jeunes enfants. Garder les petites pièces hors de portée des enfants.

### Conditions de l'entretien et de la garantie

Pour être autorisé à utiliser le produit, vous devez vous inscrire auprès de Ring et accepter les conditions d'utilisation qui figurent à l'adresse [www.ring.com/terms](http://www.ring.com/terms) (en anglais seulement).

Pour consulter les détails de votre garantie, reportez-vous au document joint à l'intérieur de l'emballage ou consultez la page [www.ring.com/warranty](http://www.ring.com/warranty) (en anglais seulement).

### RECYCLAGE ADÉQUAT DE VOTRE APPAREIL

Dans certaines régions, la mise au rebut de certains appareils électroniques est réglementée. Veuillez à éliminer ou recycler votre appareil conformément aux lois et réglementations locales. Pour en savoir plus sur le recyclage de votre appareil, consultez [www.amazon.com/devicesupport](http://www.amazon.com/devicesupport).



**WARNING:** Risk of electrical shock.

Disconnect power at the fuse or circuit breaker before installing.

Verify that the supply voltage is correct. Connect fixture to a 100 VAC~240 VAC 50/60 Hz power source.

Always follow electrical code standards when installing wired connections.

If you are outside of North America, installation and wiring must be performed by a licensed electrician.

**CAUTION:** Risk of fire.

Do not install near combustible or flammable surfaces.

## NOTICE

Do not connect this light fixture to a dimmer switch or timer.

Must be installed on a UL listed weatherproof electrical box.

## What's in the box?

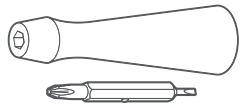

**Screwdriver & Phillips Bit**  
Use to install the box cover and tighten the security screw.

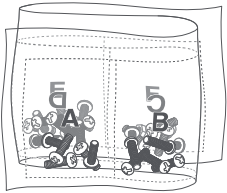

**Bag o' Screws & Washers**  
Use four screws when mounting to a round electrical box, or two when mounting to a rectangular box.

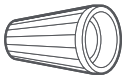

**Wire Nuts**  
Use to secure and protect wire connections.



**Hanging Hook**  
Use to hold the weatherproof box cover in position as you install.

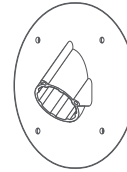

**Round Weatherproof Box Cover**  
Use to mount your Spotlight Cam on a round weatherproof electrical box.

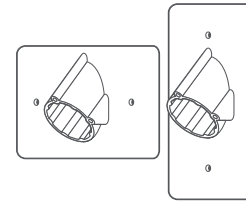

**Rectangular Weatherproof Box Covers (Vertical & Horizontal)**  
Use to mount your Spotlight Cam on a 1-gang rectangular weatherproof electrical box.

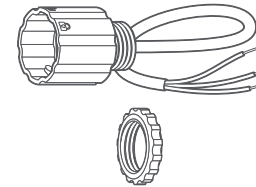

**Wiring Harness and Mounting Nut**  
Use to attach your Spotlight Cam to your chosen weatherproof box cover, and connect it to your household wiring.

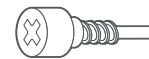

**Security Screw**  
Use to secure your Spotlight Cam to the box cover.

# How it all fits together...

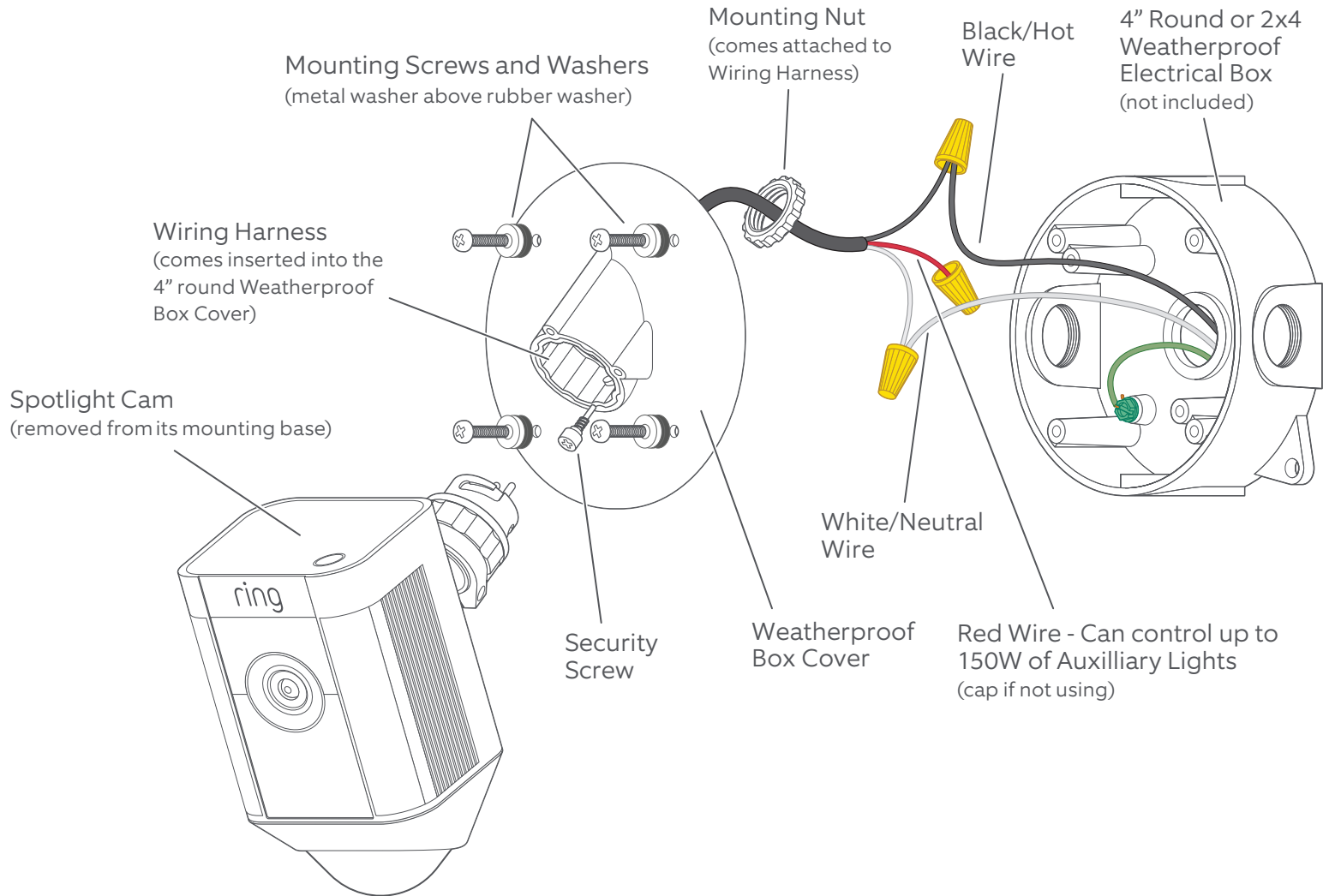

## Remove your Spotlight Cam from its base.

While holding the mounting base, turn Spotlight Cam to the left to disengage it, and set the camera aside for now.

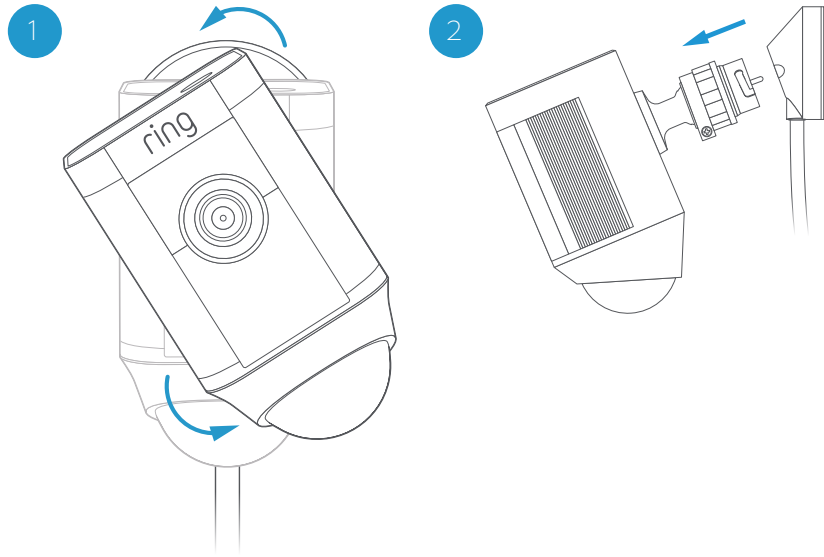

## Mounting Styles: Wall

When mounting to a vertical wall, you'll usually want the mounting port to face downwards.

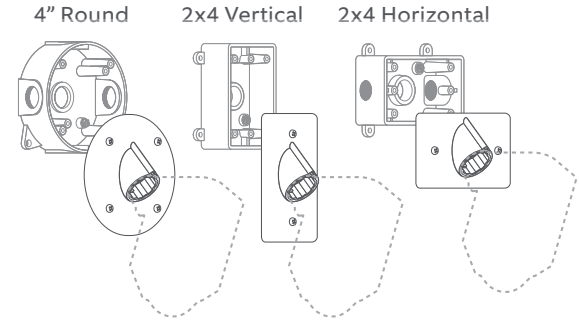

## Mounting Styles: Ceiling

If mounting to a horizontal surface, face the port in the direction you want the camera to see.

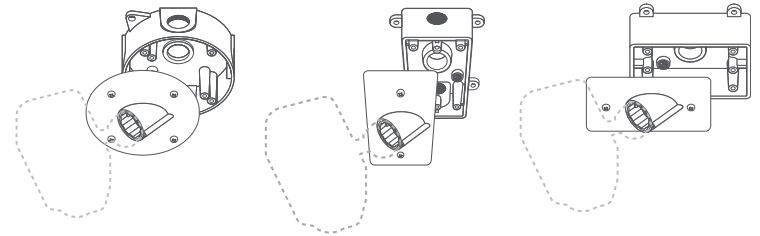

Ensure that the electrical box you use is weatherproof, including threaded plugs. Use sealant if necessary.

# Installation Height and Motion Detection

When mounted at the recommended height (9 feet up, with the motion sensor parallel to the ground), your Spotlight Cam is optimized to detect human-sized objects at up to 30 feet.

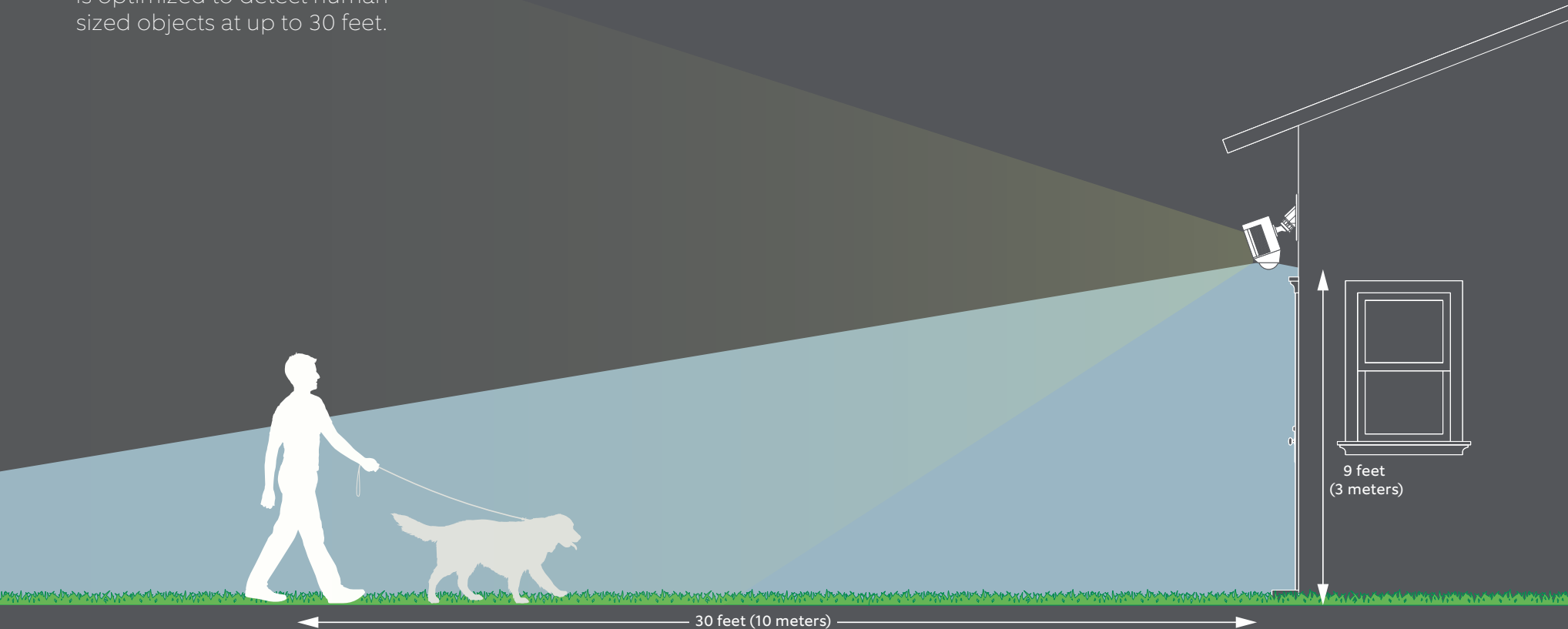
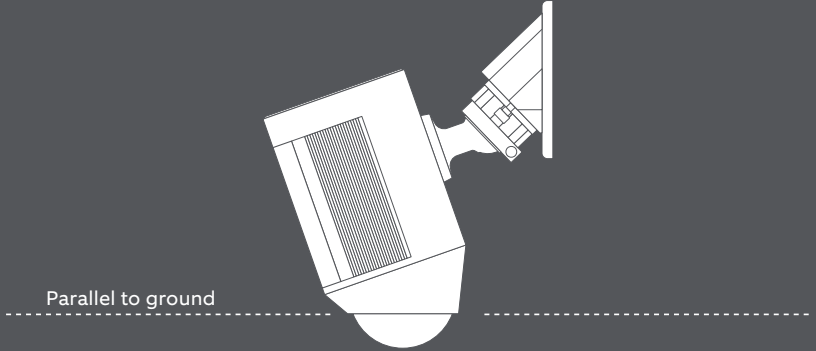

## Shut power off at the breaker.

If you don't know where your breaker is or how to turn off power to your electrical box, consult with a licensed electrician.

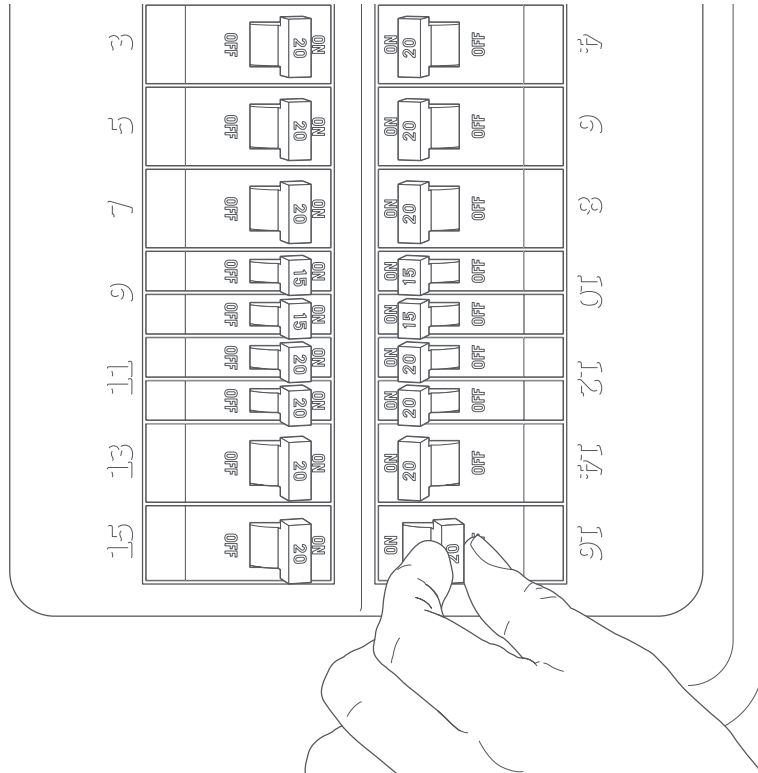

## Remove your existing light or camera. (if applicable)

**With power off at the breaker,** remove your existing floodlight or camera from the electrical box and disconnect the wires. If there is a bracket attached to your electrical box, remove that as well.

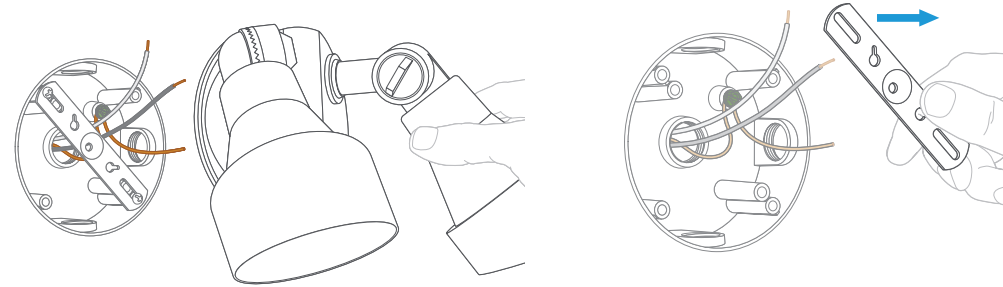

## Hang the box cover.

Inspect the box to make sure water can't get in.

Then use the included hanging hook to hold the weatherproof box cover in place as you wire it in.

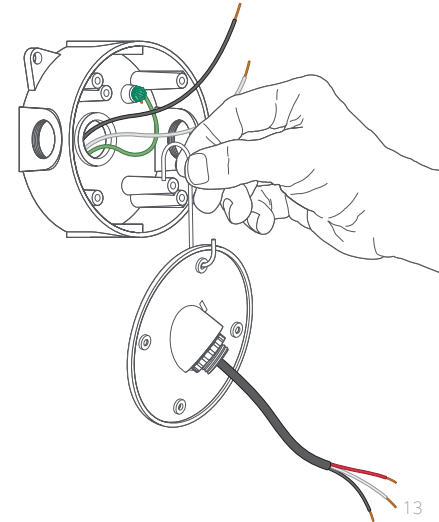

## Connect the power wires.

Connect the black and white wires on the wiring harness to the black (hot) and white (neutral) wires coming out of your electrical box.

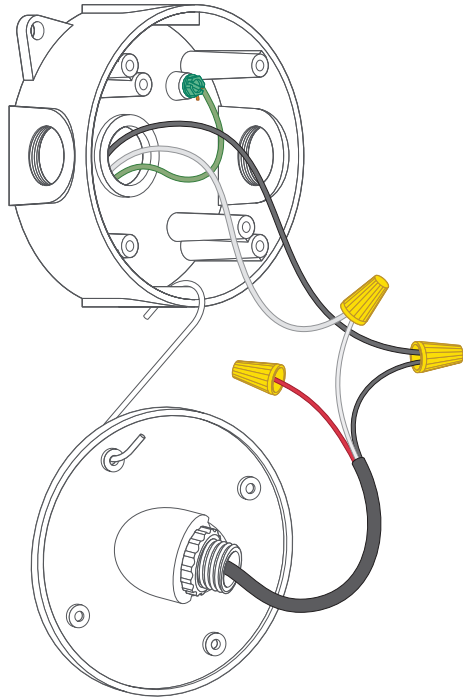

Use the included wire nuts to secure and protect the connections.

The red wire is optional, and should only be connected if you wish to control other lights with your Spotlight Cam.



If you don't have clearly colored black and white wires coming out of your electrical box, consult with a licensed electrician.

## Auxiliary Light Control

Your Spotlight Cam has an advanced motion detection system. If you'd like other lights (such as floodlights) to be triggered by the motion detector in your Spotlight Cam, wire them according to this diagram.

Your connected lights also turn on when you manually enable your Spotlight Cam lights in the Ring app.

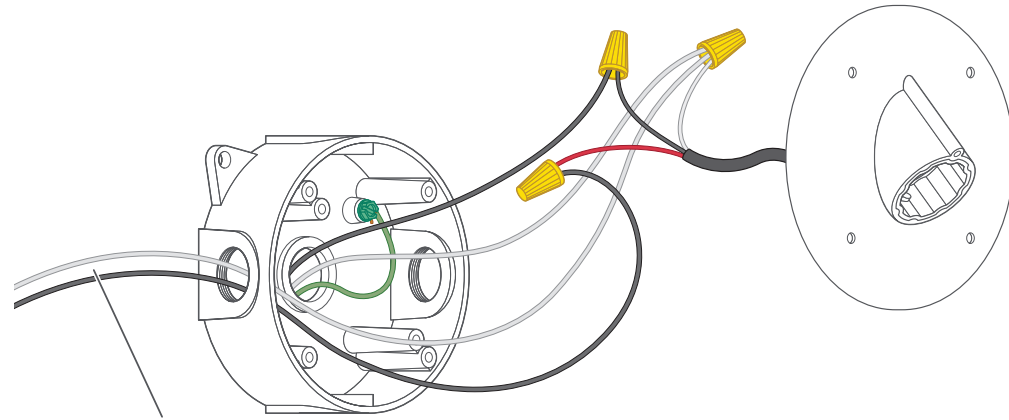

To Auxiliary  
Light Fixtures



Total power draw of connected lights must not exceed 150 watts.



## Screw in the box cover.

Use the included screws to secure the box cover to the electrical box. Be sure to add a metal washer, then a rubber washer to each screw before inserting.



Some round boxes may only take two screws. Seal unused holes in the cover with the included screws and nuts. Add a metal washer backed by a rubber washer to each side before tightening the nut.

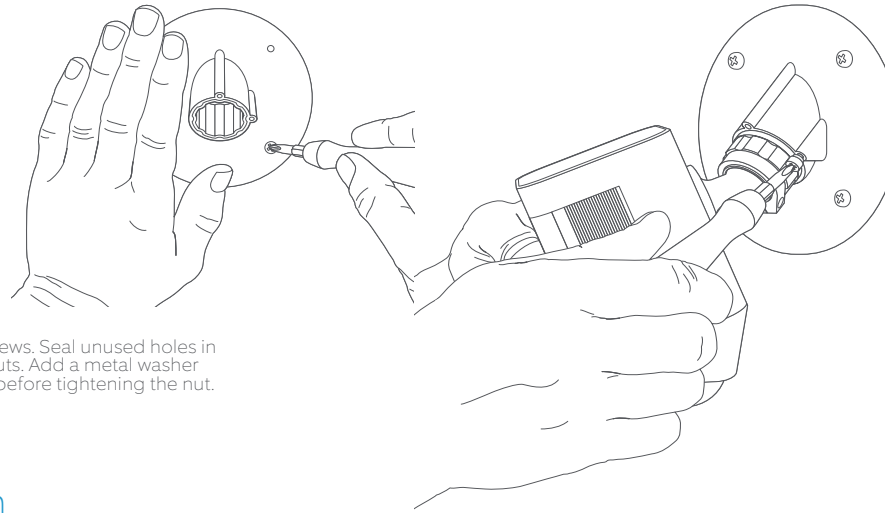

## Add the Security Screw.

Insert and tighten the security screw to lock your Spotlight Cam into the box cover.

## Mount your Spotlight Cam.

Insert your Spotlight Cam into the box cover. Once it's fully seated, turn to the right to lock it in.

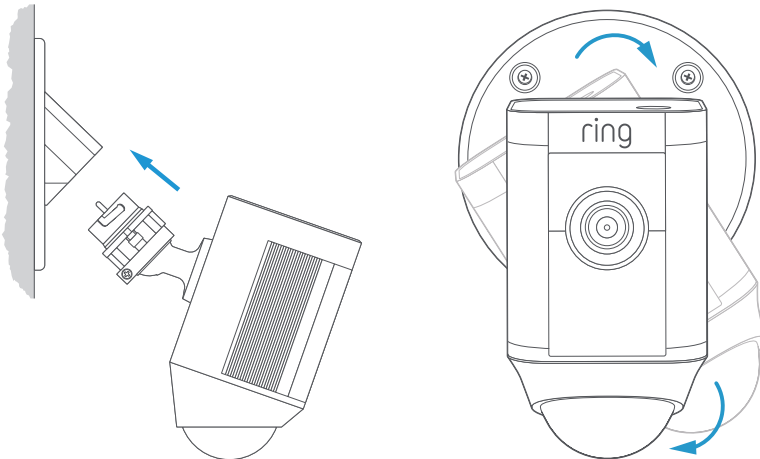

## Turn on power at the breaker.

Once your Spotlight Cam is installed, it's time to turn power back on at the breaker.

If the lights on your Spotlight Cam turn on, you're all set!

If not, turn power off at the breaker and check your connections.

## Try it out!

After setup, tap the Live View button in the Ring app to see video from your Spotlight Cam.

If you have any problems, visit [ring.com/help](https://ring.com/help).

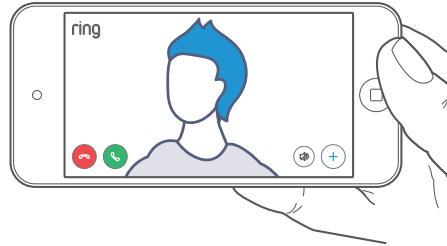

## Adjust the camera angle.

To ensure accurate motion detection, position your Spotlight Cam so the border of the motion detector is parallel with the ground.

Tighten the side screw to secure the camera position.

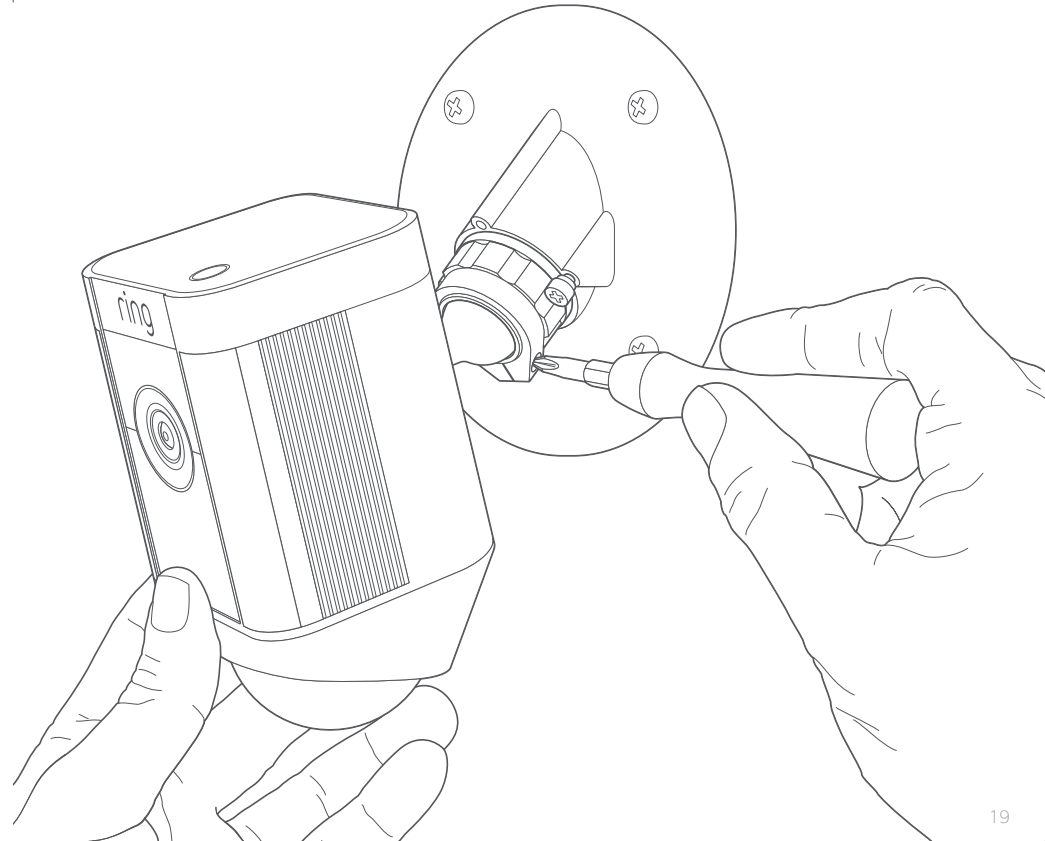

For additional help, visit: [ring.com/help](https://ring.com/help)

Or give us a call...

**US 1 800 656 1918**

---

**Canada 1 855 300 7289**

---

**Worldwide +1 310 929 7085**

---

For a list of all our customer support numbers, visit: [ring.com/callus](https://ring.com/callus)

**ring** 1523 26th St.  
Santa Monica, CA 90404

To review your warranty coverage, please visit [www.ring.com/warranty](https://www.ring.com/warranty).

© 2020 Ring LLC or its affiliates.

Ring, Always Home, and all related logos are trademarks of Ring LLC or its affiliates.